

**TROPIC WINDS CONDOMINIUM
CONDOMINIUM GROUND LEVEL
PARKING SPACES: P1-1 THRU P1-51**

**NOTE: ALL SPACES
UNDERNEATH AND
AROUND THE OUTSIDE
OF THE BUILDING ARE
RESERVED AS
INDICATED ON THE
CURB.**

**KNOW YOUR ASSIGNED
SPACE.**

**PARKING IN THE WRONG
SPACE MAY RESULT IN
YOUR VEHICLE BEING
TOWED.**

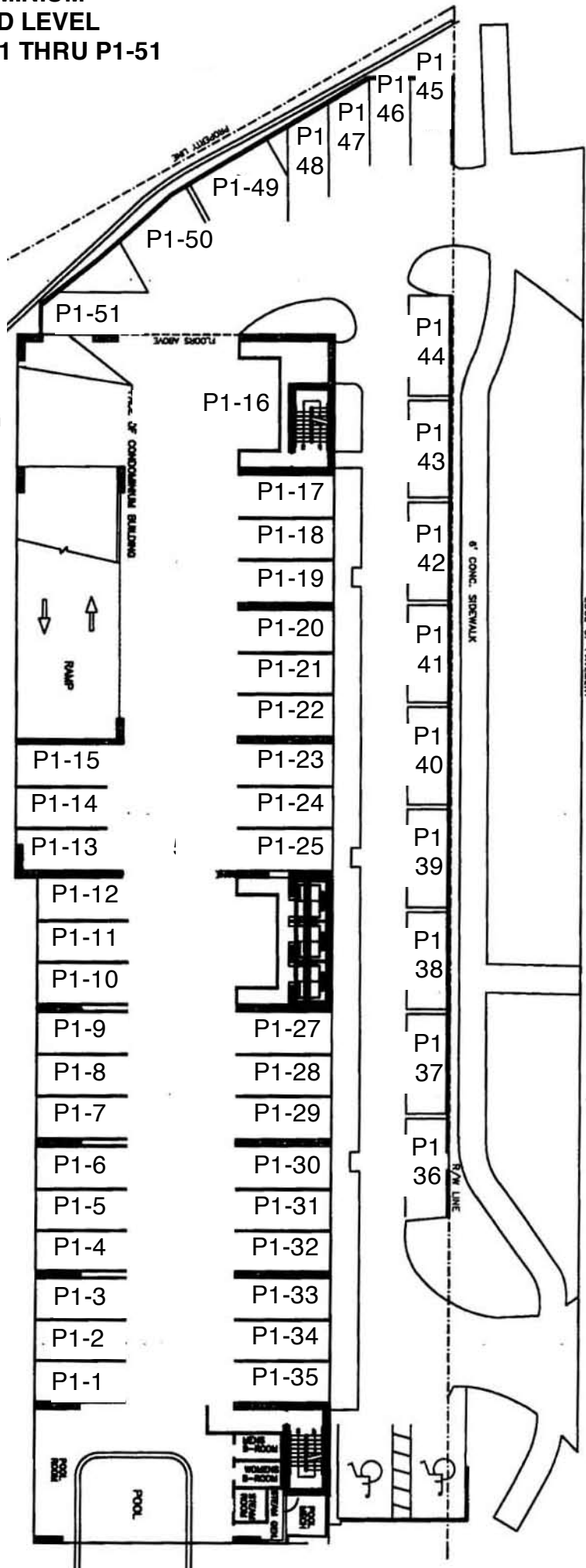

**TROPIC WINDS CONDOMINIUM
CONDOMINIUM PARKING LEVEL TWO
PARKING SPACES: P2-1 THRU P2-32**

**NOTE: ALL SPACES ON
THIS LEVEL ARE
RESERVED AS
INDICATED ON THE
CURB.**

**KNOW YOUR ASSIGNED
SPACE.**

**PARKING IN THE WRONG
SPACE MAY RESULT IN
YOUR VEHICLE BEING
TOWED.**

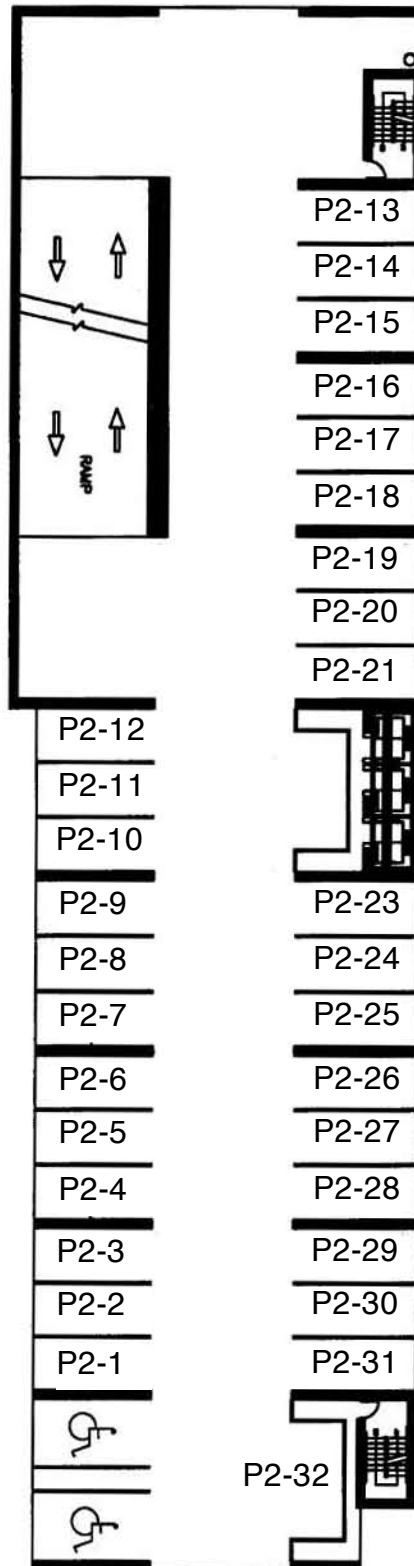

**TROPIC WINDS CONDOMINIUM
CONDOMINIUM PARKING LEVEL THREE
PARKING SPACES: P3-1 THRU P3-33**

**NOTE: ALL SPACES ON
THIS LEVEL ARE
RESERVED AS
INDICATED ON THE
CURB.**

**KNOW YOUR ASSIGNED
SPACE.**

**PARKING IN THE WRONG
SPACE MAY RESULT IN
YOUR VEHICLE BEING
TOWED.**

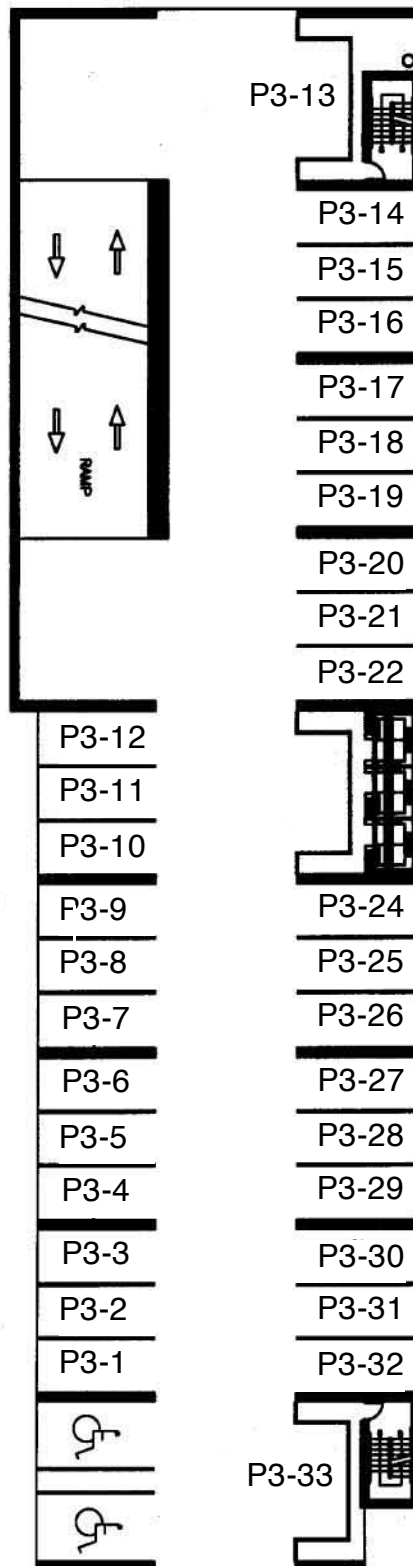

**TROPIC WINDS CONDOMINIUM
CONDOMINIUM PARKING LEVEL FOUR
PARKING SPACES: P4-1 THRU P4-39**

**NOTE: ALL SPACES ON
THIS LEVEL ARE
RESERVED AS
INDICATED ON THE
CURB.**

**KNOW YOUR ASSIGNED
SPACE.**

**PARKING IN THE WRONG
SPACE MAY RESULT IN
YOUR VEHICLE BEING
TOWED.**

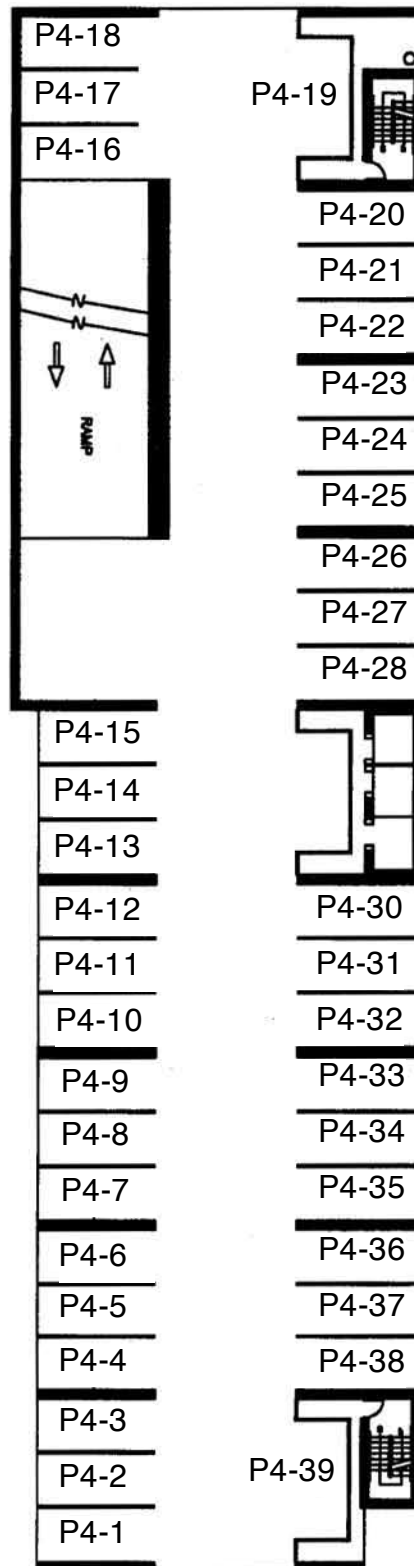

TROPIC WINDS CONDOMINIUM - NORTH GARAGE - TOP LEVEL

GREEN = OPEN PARKING SPOT (FIRST COME FIRST SERVE)

RED = RESERVED FOR SPECIFIC CONDO (TOW AWAY ZONE)

OPEN GREEN SPACES -
VISITOR VEHICLE OR
GUESTS / OWNERS
WITH AN EXTRA
VEHICLE: PARK
IN AN "OPEN"
(NON-RESERVED)
PARKING SPACE
IN THE NORTH GARAGE.

RESV. RED SPACES -
"RESERVED" PARKING
SPACES ARE
MARKED IN BLACK
ON THE CONCRETE
CURBS. RESERVED
SPACES ARE FOR A
SPECIFIC CONDO.

**UNAUTHORIZED
VEHICLES SUBJECT
TO TOW AT OWNERS
EXPENSE.**

**ALL VEHICLES MUST
HAVE A PARKING PASS
WHICH MAY BE IN YOUR
CONDO OR OBTAINED
FROM THE UNIT 805
MANAGEMENT OFFICE.**

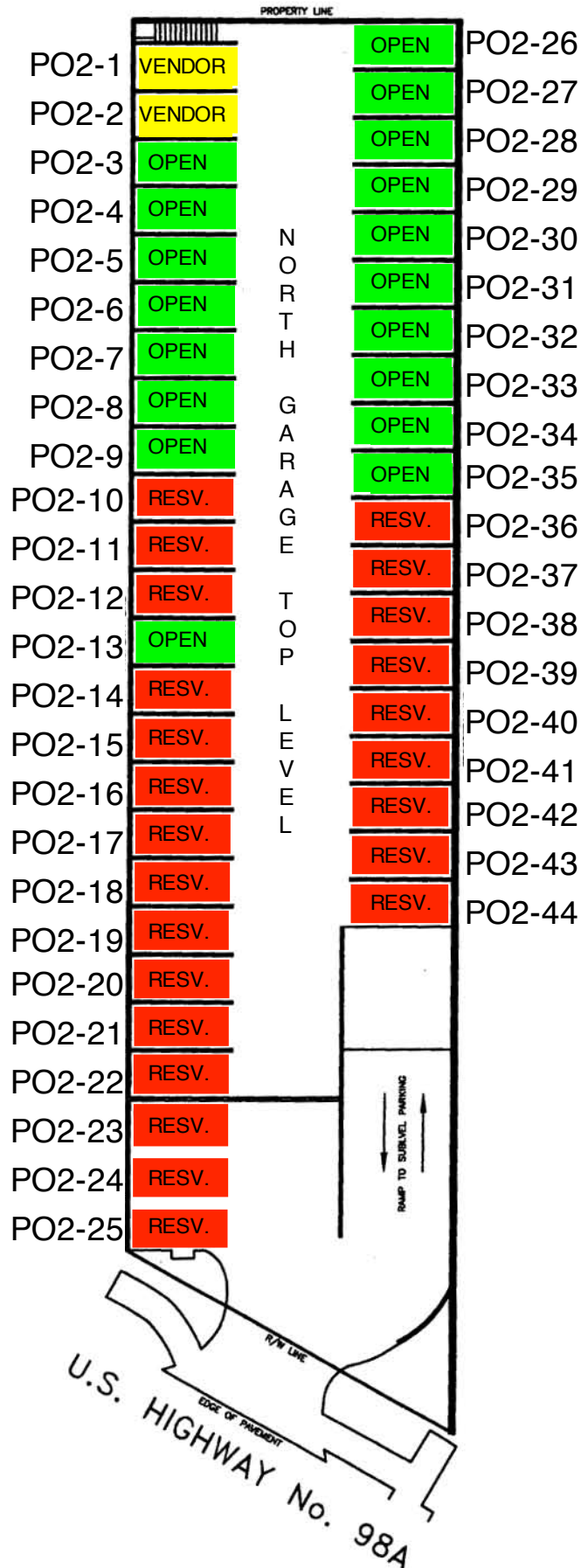

**TROPIC
WINDS
-
NORTH
GARAGE
-
TOP
STREET
LEVEL
-
SPACES
PO2-1
THRU
PO2-44**

TROPIC WINDS CONDOMINIUM - NORTH GARAGE - BOTTOM LEVEL

GREEN = OPEN PARKING SPOT (FIRST COME FIRST SERVE)

RED = RESERVED FOR SPECIFIC CONDO (TOW AWAY ZONE)

OPEN GREEN SPACES -
VISITOR VEHICLE OR
GUESTS / OWNERS
WITH AN EXTRA
VEHICLE: PARK
IN AN "OPEN"
(NON-RESERVED)
PARKING SPACE
IN THE NORTH GARAGE.

RESV. RED SPACES -
"RESERVED" PARKING
SPACES ARE
MARKED IN BLACK
ON THE CONCRETE
CURBS. RESERVED
SPACES ARE FOR A
SPECIFIC CONDO.

**UNAUTHORIZED
VEHICLES SUBJECT
TO TOW AT OWNERS
EXPENSE.**

**ALL VEHICLES MUST
HAVE A PARKING PASS
WHICH MAY BE IN YOUR
CONDO OR OBTAINED
FROM THE UNIT 805
MANAGEMENT OFFICE.**

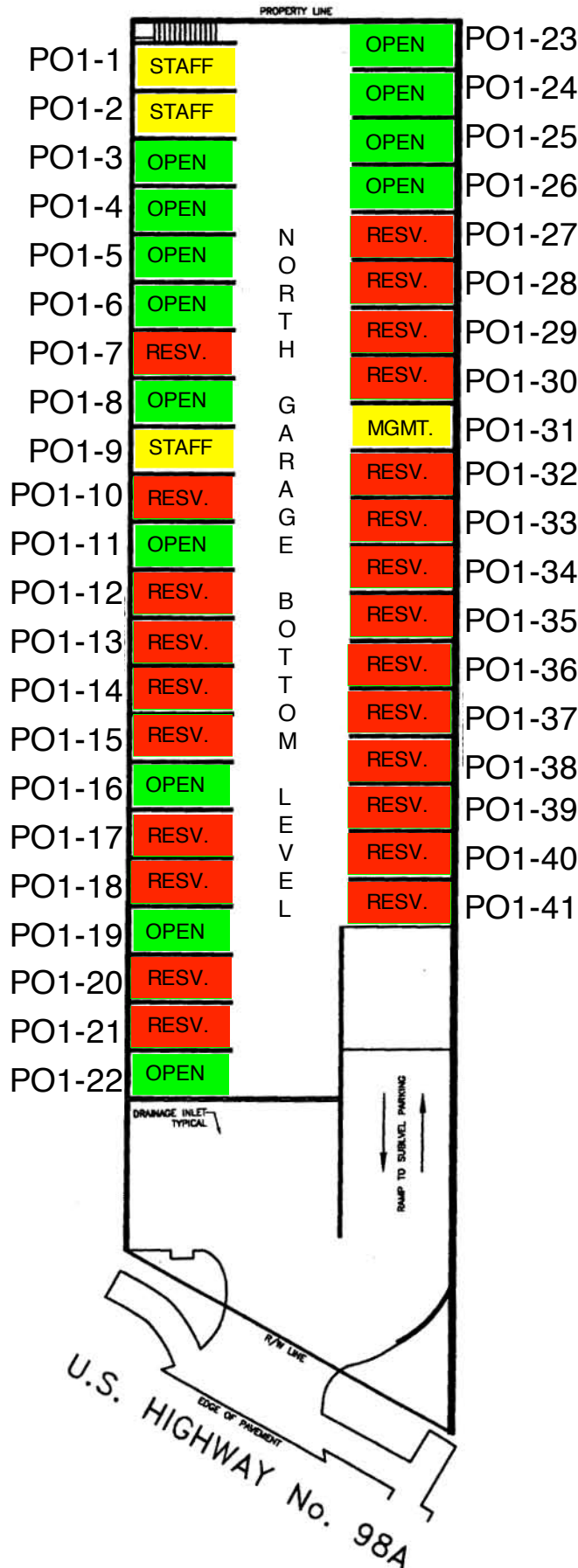

**TROPIC
WINDS
-
NORTH
GARAGE
-
BASEMENT
LEVEL
-
SPACES
PO1-1
THRU
PO1-41**